

(White)

(Black)

6-channel Digital Mixer With Power Amplifier
With Digital Effects, Media Playback And Bluetooth

* the contents of this manual are the latest technical specifications at the time of publication.

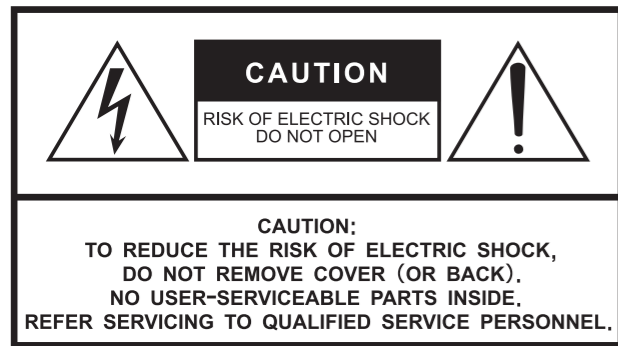

The above warning is located on the rear of the unit.

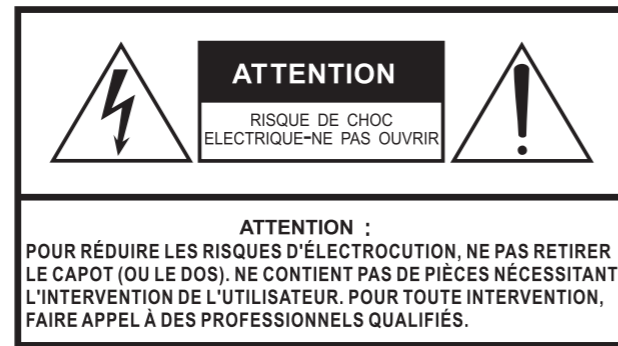

L'avertissement ci-dessus est situé sur l'arrière de l'unité. 'ave

Explanation of Graphical Symbols

Explication des symboles



The lightning flash with arrowhead symbol within an equilateral triangle is intended to alert the user to the presence of uninsulated "dangerous voltage" within the product's enclosure that may be of sufficient magnitude to constitute a risk of electric shock to persons. L'éclair avec une flèche à l'intérieur d'un triangle équilatéral est destiné à attirer l'attention de l'utilisateur sur la présence d'une « tension dangereuse » non isolée à l'intérieur de l'appareil, pouvant être suffisamment élevée pour constituer un risque d'électrocution.



The exclamation point within an equilateral triangle is intended to alert the user to the presence of important operating and maintenance (servicing) instructions in the literature accompanying the product.

Le point d'exclamation à l'intérieur d'un triangle équilatéral est destiné à attirer l'attention de l'utilisateur sur la présence d'instructions importantes sur l'emploi ou la maintenance (réparation) de l'appareil dans la documentation fournie.

IMPORTANT SAFETY INSTRUCTIONS

- 1 Read these instructions.
- 2 Keep these instructions.
- 3 Heed all warnings.
- 4 Follow all instructions.
- 5 Do not use this apparatus near water.
- 6 Clean only with dry cloth.
- 7 Do not block any ventilation openings. Install in accordance with the manufacturer's instructions.
- 8 Do not install near any heat sources such as radiators, heat registers, stoves, or other apparatus (including amplifiers) that produce heat.
- 9 Do not defeat the safety purpose of the polarized or grounding-type plug. A polarized plug has two blades with one wider than the other. A grounding type plug has two blades and a third grounding prong. The wide blade or the third prong are provided for your safety. If the provided plug does not fit into your outlet, consult an electrician for replacement of the obsolete outlet.
- 10 Protect the power cord from being walked on or pinched particularly at plugs, convenience receptacles, and the point where they exit from the apparatus.
- 11 Only use attachments/accessories specified by the manufacturer.
- 12 Use only with the cart, stand, tripod, bracket, or table specified by the manufacturer, or sold with the apparatus. When a cart is used, use caution when moving the cart/apparatus combination to avoid injury from tip-over.
- 13 Unplug this apparatus during lightning storms or when unused for long periods of time.
- 14 Refer all servicing to qualified service personnel. Servicing is required when the apparatus has been damaged in any way, such as power-supply cord or plug is damaged, liquid has been spilled or objects have fallen into the apparatus, the apparatus has been exposed to rain or moisture, does not operate normally, or has been dropped.



PRÉCAUTIONS CONCERNANT LA SÉCURITÉ

- 1 Lire ces instructions.
- 2 Conserver ces instructions.
- 3 Tenir compte de tous les avertissements.
- 4 Suivre toutes les instructions.
- 5 Ne pas utiliser ce produit à proximité d'eau.
- 6 Nettoyer uniquement avec un chiffon propre et sec.
- 7 Ne pas bloquer les orifices de ventilation. Installer l'appareil conformément aux instructions du fabricant.
- 8 Ne pas installer l'appareil à proximité d'une source de chaleur comme un radiateur, une bouche de chaleur, un poêle ou tout autre appareil (y compris un amplificateur) produisant de la chaleur.
- 9 Ne pas modifier le système de sécurité de la fiche polarisée ou de la fiche de terre. Une fiche polarisée dispose de deux broches dont une est plus large que l'autre. Une fiche de terre dispose de deux broches et d'une troisième pour le raccordement à la terre. Cette broche plus large ou cette troisième broche est destinée à assurer la sécurité de l'utilisateur. Si la fiche équipant l'appareil n'est pas compatible avec les prises de courant disponibles, faire remplacer les prises par un électricien.
- 10 Acheminer les cordons d'alimentation de sorte qu'ils ne soient pas piétinés ni coincés, en faisant tout spécialement attention aux fiches, prises de courant et au point de sortie de l'appareil.
- 11 Utiliser exclusivement les fixations et accessoires spécifiés par le fabricant.
- 12 Utiliser exclusivement le chariot, le stand, le trépied, le support ou la table recommandés par le fabricant ou vendus avec cet appareil. Si l'appareil est posé sur un chariot, déplacer le chariot avec précaution pour éviter tout risque de chute et de blessure.
- 13 Débrancher l'appareil en cas d'orage ou lorsqu'il doit rester hors service pendant une période prolongée.
- 14 Confier toute réparation à un personnel qualifié. Faire réparer l'appareil s'il a subi tout dommage, par exemple si la fiche ou le cordon d'alimentation est endommagé, si du liquide a coulé ou des objets sont tombés à l'intérieur de l'appareil, si l'appareil a été exposé à la pluie ou à de l'humidité, si l'appareil ne fonctionne pas normalement ou est tombé.



WARNING
TO REDUCE THE RISK OF FIRE OR ELECTRIC SHOCK, DO NOT EXPOSE THIS APPARATUS TO RAIN OR MOISTURE.

AVERTISSEMENT
POUR RÉDUIRE LES RISQUES D'INCENDIE OU DE DÉCHARGE ÉLECTRIQUE, N'EXPOSEZ PAS CET APPAREIL À LA PLUIE OU À L'HUMIDITÉ.

FCC INFORMATION (U.S.A.)

1. **IMPORTANT NOTICE: DO NOT MODIFY THIS UNIT!**
This product, when installed as indicated in the instructions contained in this manual, meets FCC requirements. Modifications not expressly approved by the FCC, to use the product.
2. **IMPORTANT:** When connecting this product to accessories and/or another product use only high quality shielded cables. Cable/s supplied with this product **MUST** be used. Follow all installation instructions. Failure to follow instructions could void your FCC authorization to use this product in the USA.
3. **NOTE:** This product has been tested and found to comply with the requirements listed in FCC Regulations, Part 15 for Class "B" digital devices. Compliance with these requirements provides a reasonable level of assurance that your use of this product in a residential environment will not result in harmful interference with other electronic devices. This equipment generates/uses radio frequencies and, if not installed and used according to the instructions found in the users manual, may cause interference harmful to the operation of other electronic devices. Compliance with FCC regulations does not guarantee that interference will not occur in all

installations. If this product is found to be the source of interference, which can be determined by turning the unit "OFF" and "ON", please try to eliminate the problem by using one of the following measures:
Relocate either this product or the device that is being affected by the interference.
Utilize power outlets that are on different branch (circuit breaker or fuse) circuits or install AC line filter/s.
In the case of radio or TV interference, relocate/reorient the antenna. If the antenna lead-in is 300 ohm ribbon lead, change the lead-in to co-axial type cable.
If these corrective measures do not produce satisfactory results, please contact the local retailer authorized to distribute this type of product.

* This applies only to products sold in the United States

(class B)

COMPLIANCE INFORMATION STATEMENT

DECLARATION OF CONFORMITY PROCEDURE

Type of Equipment : Mixing Console

This device complies with Part 15 of the FCC Rules.

Operation is subject to the following two conditions:

- 1) this device may not cause harmful interference, and
- 2) this device must accept any interference received including interference that may cause undesired operation.

See user manual instructions if interference to radio reception is suspected.

* This applies only to products sold in the United States

(FCC DoC)

IMPORTANT NOTICE FOR THE UNITED KINGDOM

Connecting the Plug and Cord

WARNING: THIS APPARATUS MUST BE EARTHED IMPORTANT. The wires in this mains lead are coloured in accordance with the following code:

GREEN-AND-YELLOW : EARTH
BLUE : NEUTRAL
BROWN : LIVE

As the colours of the wires in the mains lead of this apparatus may not correspond with the coloured markings identifying the terminals in your plug proceed as follows:

The wire which is coloured GREEN-and-YELLOW must be connected to the terminal in the plug which is marked by the letter E or by the safety earth symbol ⊕ or colored GREEN or GREEN-and-YELLOW.

The wire which is coloured BLUE must be connected to the terminal which is marked with the letter N or coloured BLACK.

The wire which is coloured BROWN must be connected to the terminal which is marked with the letter L or coloured RED.

(3 wires)

이 기기는 가정용(B급) 전자파적합기기로서 주로 가정에서 사용하는 것을 목적으로 하며, 모든 지역에서 사용할 수 있습니다.

(class b korea)

In Finland: Laite on liitettävä suojamaadoituskoskettimilla varustettuun pistorasiaan.

In Norway: Apparatet må tilkoples jordet stikkontakt.

In Sweden: Apparaten skall anslutas till jordat uttag.

(class I hokuo)

Information for users on collection and disposal of old equipment:



This symbol on the products, packaging, and/or accompanying documents means that used electrical and electronic products should not be mixed with general household waste. For proper treatment, recovery and recycling of old products, please take them to applicable collection points, in accordance with your national legislation.

By disposing of these products correctly, you will help to save valuable resources and prevent any potential negative effects on human health and the environment which could otherwise arise from inappropriate waste handling.

For more information about collection and recycling of old products, please contact your local municipality, your waste disposal service or the point of sale where you purchased the items.

For business users in the European Union:

If you wish to discard electrical and electronic equipment, please contact your dealer or supplier for further information.

Information on Disposal in other Countries outside the European Union:

This symbol is only valid in the European Union. If you wish to discard these items, please contact your local authorities or dealer and ask for the correct method of disposal.

PRECAUTIONS

PLEASE READ CAREFULLY BEFORE PROCEEDING

Please keep this manual in a safe place for future reference.

WARNING

Always follow the basic precautions listed below to avoid the possibility of serious injury or even death from electrical shock, short-circuiting, damages, fire or other hazards. These precautions include, but are not limited to, the following:

Do not open

- This device contains no user-serviceable parts. Do not open the device or attempt to disassemble the internal parts or modify them in any way. If it should appear to be malfunctioning, discontinue use immediately and have it inspected by qualified service personnel.

Water warning

- Do not expose the device to rain, use it near water or in damp or wet conditions, or place on it any containers (such as vases, bottles or glasses) containing liquids which might spill into any openings. If any liquid such as water seeps into the device, turn off the power immediately and disconnect the USB cable from the computer. Then have the device inspected by qualified service personnel.
- Never insert or remove a USB cable with wet hands.

Fire warning

- Do not put burning items, such as candles, on the unit. A burning item may fall over and cause a fire.

If you notice any abnormality

- When one of the following problems occur, immediately turn off the power switch and disconnect the USB cable from the computer. Then have the device inspected service personnel.
 - The USB cable becomes frayed or damaged.
 - It emits unusual smells or smoke.
 - Some object has been dropped into the device.
 - There is a sudden loss of sound during use of the device.

- If this device should be dropped or damaged, immediately turn off the power switch, disconnect the USB cable from the computer, and have the device inspected by qualified service personnel.

CAUTION

Always follow the basic precautions listed below to avoid the possibility of physical injury to you or others, or damage to the device or other property. These precautions include, but are not limited to, the following:

Location

- Do not place the device in an unstable position where it might accidentally fall over.
- Do not place the device in a location where it may come into contact with corrosive gases or salt air. Doing so may result in malfunction.
- Before moving the device, remove all connected cables.

Connections

- Before connecting the device to other devices, turn off the power for all devices. Before turning the power on or off for all devices, set all volume levels to minimum.

Maintenance

- Remove the USB cable from a computer when cleaning the device.

Handling caution

- Do not insert your fingers or hands in any gaps or openings on the device.
- Avoid inserting or dropping foreign objects (paper, plastic, metal, etc.) into any gaps or openings on the device. If this happens, turn off the power immediately and disconnect the USB cable from the computer. Then have the device inspected by qualified service personnel.
- Do not rest your weight on the device or place heavy objects on it, and avoid use excessive force on the buttons, switches or connectors
- Do not use speakers or headphones for a long period of time at a high or uncomfortable volume level, since this can cause permanent hearing loss. If you experience any hearing loss or ringing in the ears, consult a physician.

cannot be held responsible for damage caused by improper use or modifications to the device, or data that is lost or destroyed.

NOTICE

To avoid the possibility of malfunction/ damage to the product, damage to data, or damage to other property, follow the notices below.

■ Handling and maintenance

- Do not use the device in the vicinity of a TV, radio, stereo equipment, mobile phone, or other electric devices. Otherwise, the device, TV, or radio may generate noise.
- Do not expose the device to excessive dust or vibration, or extreme cold or heat (such as in direct sunlight, near a heater, or in a car during the day), in order to prevent the possibility of panel disfiguration, unstable operation, or damage to the internal components.
- Do not place vinyl, plastic or rubber objects on the device, since this might discolor the panel.
- When cleaning the device, use a dry and soft cloth. Do not use paint thinners, solvents, cleaning fluids, or chemical-impregnated wiping cloths.
- Condensation can occur in the device due to rapid, drastic changes in ambient temperature—when the device is moved from one location to another, or air conditioning is turned on or off, for example. Using the device while condensation is present can cause damage. If there is reason to believe that condensation might have occurred, leave the device for several hours without turning on the power until the condensation has completely dried out.
- Avoid setting all equalizer controls and faders to their maximum. Depending on the condition of the connected devices, doing so may cause feedback and may damage the speakers.
- Do not apply oil, grease, or contact cleaner to the faders. Doing so may cause problems with electrical contact or fader motion.
- When turning on the AC power in your audio system, always turn on the power amplifier LAST, to avoid speaker damage. When turning the power off, the power amplifier should be turned off FIRST for the same reason.
- When the device no working a long time, please set the switch to the standby position.

■ Connectors

XLR-type connectors are wired as follows (IEC60268 standard): pin 1: ground, pin 2: hot (+), and pin 3: cold (-).

Information

■ About this manual

- The illustrations as shown in this manual are for instructional purposes only.
- Steinberg and Cubase are registered trademarks of Steinberg Media Technologies GmbH.
- The company names and product names in this manual are the trademarks or registered trademarks of their respective companies.

Contents

Cautions.....1

INSTALL SAMPLE(FRONT PANEL)6

Control mode and function7

MIC/LINE7

MAIN OUT7

AUX7

PHONES7

HEADSET-MIC(3.5).....7

HEADSET-PHONE(3.5).....7

GAIN7

HIGH7

LOW7

EFF AUX Knod7

PAN7

ON Switch8

FADER8

SOLO8

PEAK LED8

USB8

Level meter LED8

PHANTOM / +48V LED8

Product Electricity8

Effect of module9

PLAY MODE9

FX/USB Key9

Display9

PARAMETER Knod9

Introduction to operation9

STEREO GRAPHIC EQ.....9

PHONE Knod.....9

Back panel input/output function ..10

Insurance pipe (6A)10

COOLING FANS10

SPEAKER JACK10

Specifications11

INSTALL SAMPLE FRONT PANEL

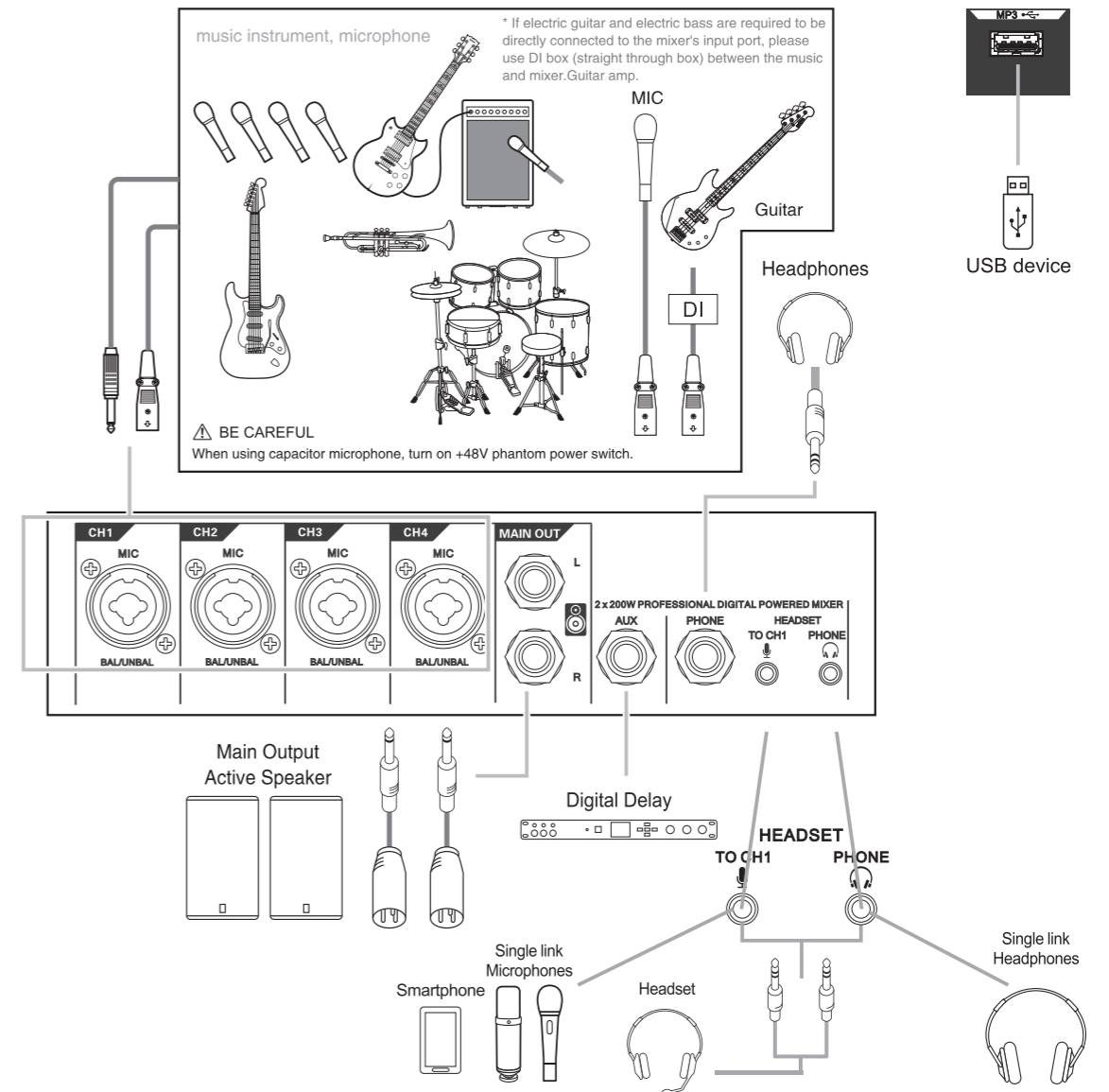

Connection Example Rear panel

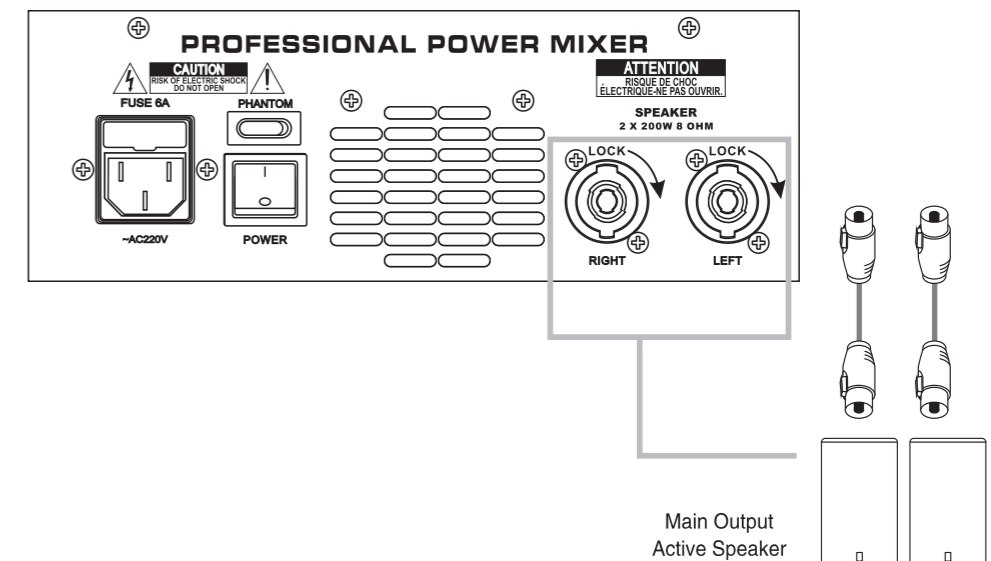

CONTROL MODE AND FUNCTION

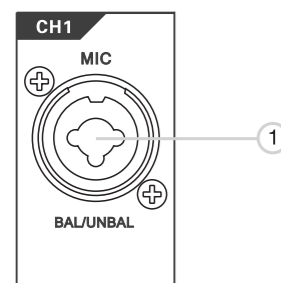

1. MIC/LINE

For connecting to a microphone, an instrument, or an audio device. These jacks support both XLR and phone plugs.

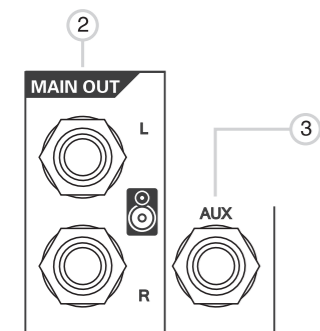

2. [MAIN OUT]

Used for connecting power amplifier, active output speaker and external recording equipment. These plugs support phone type plugs (balanced/unbalanced)

3. AUX SEND Jacks

You use these jacks, for example, to connect to an external effect device or a stage/studio monitoring system. These are impedance-balanced "phone" -type output jacks.

■ Impedance-balanced
Since the hot and cold terminals of impedance-balanced output jacks have the same impedance, these output jacks are less affected by induced noise.

4. PHONES Jacks

For connecting headphones. The socket supports stereo phone plug. If you need to connect headsets or earplugs with mini plugs, please use a switch device to connect.

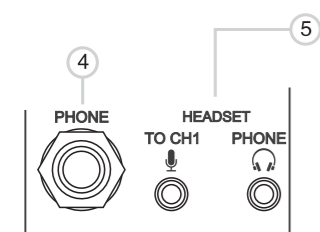

5. [HEADSET] microphone [input] jack

For connecting to the microphone for your headset. The audio input here is sent to channel 1.

[HEADSET] headphones [output] jack

For connecting to the headphone for your headset.

6. GAIN

Sets the volume of the microphone or line input signal provided to this channel. The GAIN knob is used to adjust the sensitivity of the microphone and the input signal of the circuit. This allows external signals to be adjusted to the desired internal control level.

7. HIGH

Control the high frequency tone of each channel. Always set this control to the 12 o'clock position, but you can control the high frequency tone according to the speaker, the conditions of listening position and listener's taste. Clockwise rotation of the control increases level.

8. LOW

Control the low frequency tone of each channel. Always set this control to the 12 o'clock position, but you can control the low frequency tone according to the speaker, the conditions of listening position and listener's taste. Clock wise rotation of the control increase the level.

9. EFF/AUX Knod

These knobs take advantage of each channel's signal sent to the in-machine effect after processing and return to the stereo main channel.

Channel fader, mute and other channel controls affect the effect output, but the sound phase adjustment does not (effect assist is behind the movers).

10. PAN

The pan control sends continuously variable amounts of the post fader signal to either the left or right main busses. In the center position equal amounts of signal are sent to the left and right busses.

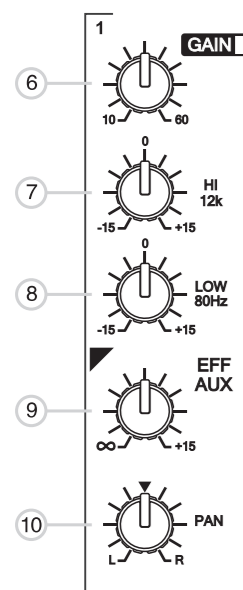

11. ON Switches

Turning this switch on (ON) sends that channel's signal to the buses. When the switch is turned on, the switch's lamp comes on. If you turn the switch off (OFF), all of the signal sent to the buses such as AUX and GROUP buses is cut off.

NOTE

- The ON switch does not affect the operation of the SOLO switch. You can monitor the channel's pre-fader signal through the PHONES jack even when the ON switch is off.
- To reduce noise, turn all unused channels off.

12. FADER

The level of channel signals. Use these controllers to balance multiple channels.

Note: to minimize noise, minimize the size of the pins on unused channels.

13. SOLO

This lovable switch allows you to hear signals through your headphones or control room without having to route them to the main mix. You don't even have to have the channel's fader turned up. Folks use solo in live work to preview channels before they are let into the mix, or to just check out what a particular channel is up to anytime during a session. You can solo as many channels at a time as you like.

14. PEAK LED

Lights when the volume of input sound is too high. If it is lit, turn the [GAIN] knob to the left to lower the volume.

15. USB

This USB interface, a machine built-in MP3 player and recorder, support format: MP3, WAV, WMA.

■ flash memory capacity and format

USB flash operation has been proven to be compatible with up to 64GB flash. (there is no guarantee that it will work with all types of USB flash memory.) Support for FAT16 and FAT32 formats

■ Avoid accidental deletion

Some USB flash devices have protection Settings to prevent data from being accidentally deleted. If your flash device contains important data, it is strongly recommended that you use write protection Settings to prevent data from being accidentally deleted.

16. LEVEL METER

The left and right level meters of the mixer are composed of two columns of 5 led lamps, led each has three colors to refer to Show the range of the level.

17. [+48V]LED+PHANTOM Switch

When the phantom power switch is turned on, the [+48V]LED light will light up and the DC +48V phantom power will be supplied to the XLR plug on [MIC/LINE] input socket. Turn this on when using a condenser microphone that requires phantom power.

NOTICE

Be sure to leave this switch off if you do not need phantom power.

Follow the important precautions below, in order to prevent noise and possible damage to external devices as well as the mixer if you turn this switch on.

1. Be sure to leave this switch off when you connect a device that does not support phantom power to channel 1.
2. Make sure to turn this switch off when connecting/disconnecting a cable to/from channel 1.
3. Slide the fader on channel 1 to minimum before turning this switch on /off.

18. PRODUCT ELECTRICITY

1. [AC] Jack

Standard iec power interface, if the power line provided by this mixer, can also use professional video recorder, musical instruments, computer three-hole iec wire connection.

2. [POWER] Switch

Turns power to the unit on or off. Press the switch to the "I" position to turn on the power. Press the switch to the "O" position to turn off the power.

3. [POWER] LED

The indicator on the mixer will light up when the POWER switch is turned on



WARNING:

- Do not remove the ground pin of the plug.
- Use in strict accordance with the labeled voltage of the product.
- Rapidly turning the unit on and off in succession can cause it to malfunction. After turning the unit off, wait for at least 6 seconds before turning it on again.
- Note that the trace current continues to flow even while the switch is in the off position. If you do not plan to use the mixer for a while, be sure to unplug the power cord from the wall outlet.

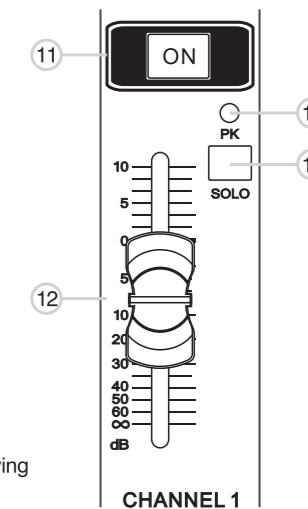

CHANNEL 1

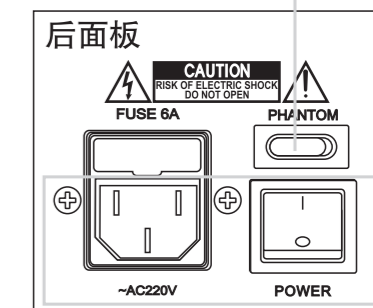
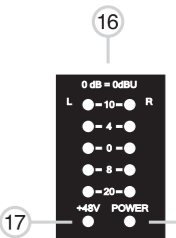
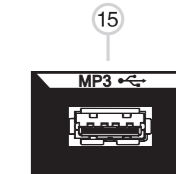

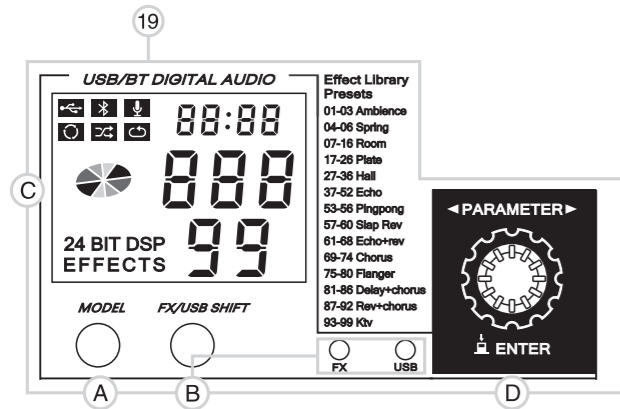

19. EFFECT OF MODULE

A. PLAY MODE Buttons

Used to switch between various functional modes.

B. FX/USB Switch Buttons

Used between the PARAMETER encoder and the type of player and effect Control switch. (When FX/USB is selected, the LED to the button will light up)

C. DISPLAY

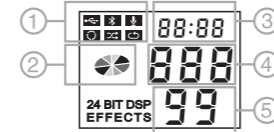

1. Function Display
2. Display the running status or bluetooth connection status
3. song time display
4. song number display
5. effect types (please refer to the list of effects on the Right)

Effect Library Presets	
01-03	Ambience
04-06	Spring
07-16	Room
17-26	Plate
27-36	Hall
37-52	Echo
53-56	Pingpong
57-60	Slap Rev
61-68	Echo+rev
69-74	Chorus
75-80	Flanger
81-86	Delay+chorus
87-92	Rev+chorus
93-99	Ktv

PARAMETER

- 1.DISPLAY 2.Rotary Knob

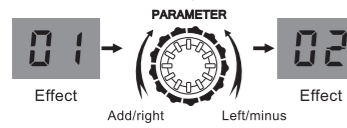

Turn to select the effect type and it will take effect automatically.

[FX/USB] Switch Buttons

- 1.DISPLAY 2.Rotary Knob

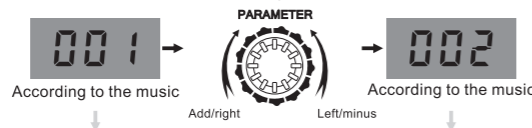

Rotate the selected track and press Confirm the current selection and play. In the play

Operational control instructions

- A. PLAY MODE (touch the button) : Short press: pre-selected MODE, corresponding MODE ICONS flash display, successively as Usb flash disk, Bluetooth, recording, Sequential play, random play, single loop (short press the PARAMETER key to confirm switch).
- B. PLAY MODE (touch the button) : Long press: 1. Under the recording MODE, stop recording, enter the recording file MODE. 2. In the non-recording mode, you can quickly enter the recording file mode.
- C. PARAMETER (encoder key) : Short press: 1. Control operation or suspension (including playing and recording). 2. Mode icon flashing, confirm the switch current scintillation display mode. 3. The rotation encoder to primary play songs, the corresponding songs to confirm.
- D. PARAMETER (encoder key) : Long press: 1. Control stop (including playing and recording). 2. When recording has stopped, but into play the recording file mode. 3. In bluetooth mode, can disconnect the bluetooth connection.
- E. Encoder: 1. When playing usb flash drive, pre-select the playlist. 2. Switch up/down when bluetooth and recording files are playing.
- F. When playing the recording file, display the U disk and the recording icon at the same time for indication.

20. STEREO GRAPHIC EQ

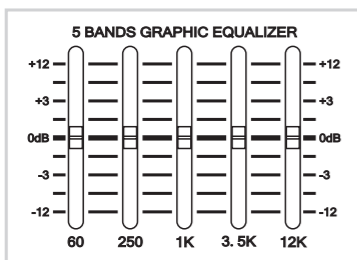

This 5-band graphic equalizer adjusts the main mix output. It affects the line-level outputs. It may also be quickly bypassed using the EQ in/bypass switch. Each slider adjusts the level of its frequency band, with up to 15 dB of boost or cut, and no change in level at the center (0 dB) position. The frequency bands are 60, 250, 1K, 3.5K, 12KHz. The EQ section comes before the main fader and meters. As with the channel EQ, just take it easy. There is a large amount of adjustment, and if you are not careful, you can upset the delicate balance of nature. Although it may not seem cool to actually turn down controls, with EQ it is often your best option. Turn down the offending frequency range, rather than boost the wanted range. Use it to reduce the level of some frequency bands where feedback occurs.

21. PHONE

Adjust the volume to headphones and Powered monitor speakers connected to the headphones output jack.

Backside of Mixer

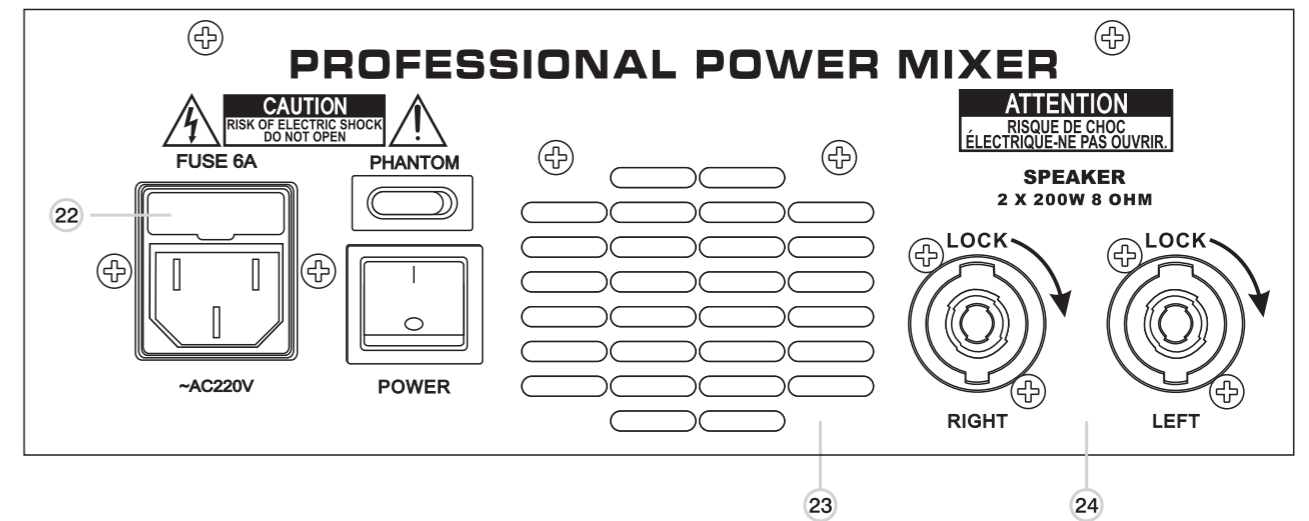

22.6A FUSE

When the device fails internally, the fuse will cut off to prevent greater problems.

23.COOLING FANS

This is a power amplifier cooling fan that prevents the temperature from rising and discharging the heat from the machine.

24.SPEAKER JACK

These are balanced XLR output sockets used for output hybrid stereo signals. The signals output by these plugs are regulated via a stereo master pusher. With its power amplifier output, the maximum power of 200W / 8 Ω can only carry speakers above 8 inches.

